

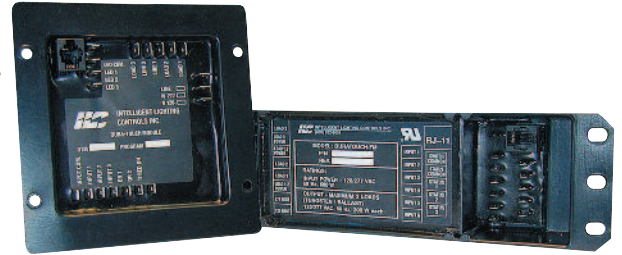

DURA Touch

Self-Contained Programmable Lighting Controller

- Vandal-resistant switching and control
- Self contained programmable lighting controller
- Factory or field programmability.
- Programmable Switching sequences
- Completely Solid State
- All programming based on IF/THEN logic for the ultimate in programmability
- 1 to 3 Momentary or Maintained switch inputs
- Junction box or fixture mount enclosure
- 1 timed ON input
- Master and secondary override inputs
- 1 to 3 Loads – 200 Watts each, 600 watts total
- Zero cross switching
- 120 or 277 VAC operation
- Interfaces with virtually any switch type, Momentary or Maintained
- UL approval



Specialty Products

Overview

DuraTouch provides for the ultimate in flexibility and durability. DuraTouch combines the features and functions of a programmable controller with the durability and reliability of a vandal-resistant lighting controller. The result is simply the most flexible and capable device of its type available. From simple ON / OFF cell lighting control to complex switching schemes involving timed inspection switches and remote overrides the DuraTouch is more than ready for the task. Unlike similar products which are pre-programmed at the factory and cannot be changed in the field. The DuraTouch is equipped with a serial communications port which when connected to a standard P.C. or laptop with Windows Based Graphic User Interface Software may be reprogrammed in the field as many times as may be required.

Features

Completely Self Contained:

- Each DuraTouch is a complete self-contained programmable lighting controller that includes:
 - Power supply 120 or 277 VAC
 - Solid state load circuit drivers
 - Status/Pilot light LED drives
 - Programming interface
 - EEPROM Memory for non-volatile storage of user programs

One to Three Load Circuits

- Each DuraTouch is supplied with three load circuits, each capable of controlling up to 200 Watts each
- Up to 600 watts per DuraTouch module

Multitude of Switch Input Types and Functions

- DuraTouch has been designed to accept virtually any switch input type from simple dry contact switches to sophisticated touch activated devices
- Switch inputs may be programmed to respond to Maintained or Momentary contact switches
- Momentary (action takes place on contact closure only)

- Maintained (action takes place on contact closure and opening)
- Timer input may be programmed for a duration of 1 second to 120 minutes

Unmatched Programmability

- DuraTouch in combination with Windows-based Graphic User Interface software provides programmability and flexibility that is unequalled in the industry.
- With simple point-and-click commands virtually anyone can reprogram the DuraTouch to perform the desired task.
- Unlike competitive products that must be purchased with the desired switching sequence and all options installed at the factory, DuraTouch is field programmable and modifiable.

Automatic Emergency Power-Up Mode

- Each DuraTouch module is supplied with a programmable automatic emergency power-up feature that causes the DuraTouch module to power-up to a known state after an interruption in power, such as may be the case after an electrical storm or other interruption in normal power.



INTELLIGENT LIGHTING CONTROLS, INC.

5229 Edina Industrial Boulevard
 Minneapolis, Minnesota 55439
 Phone 952 829 1900
 FAX 952 829 1901
 1-800-922-8004
 www.ilc-usa.com



DURA Touch

Self-Contained Programmable Lighting Controller

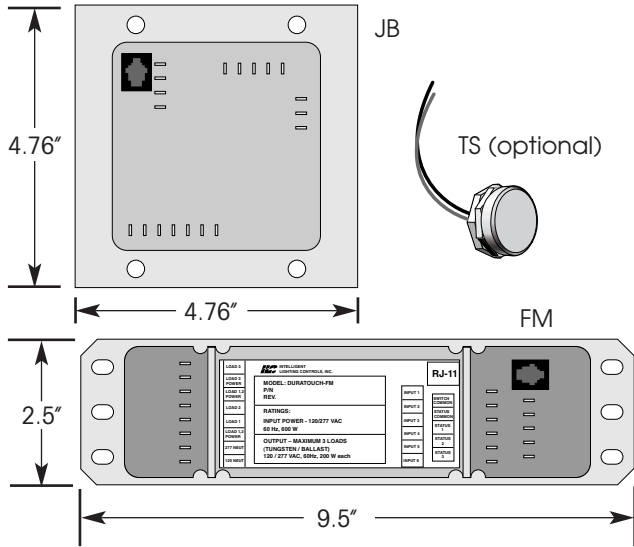

Physical Dimensions

Measurements			
Item	Width	Height	Depth
DuraTouch JB (Junction Box Mount)	4.76 In.	4.76 In.	1.5 In.
DuraTouch FM (Fixture Mount)	9.5 In.	2.5 In.	1.5 In.

Specifications

Physical:

- Two packaging options are available.
 - 4¹¹/₁₆" electrical junction box mounting
 - Fixture mount 9.5" X 2.5" X 1.5" designed to mount in ballast tray of fluorescent fixtures

Electrical:

- 120 or 277 VAC
- 1-3 Outputs
- 200 Watts per output (600 Watts total) 120 or 277 VAC resistive or inductive loads
- Maximum Inrush: 4 Amps for 1 cycle, 2 minutes between cycles

Operating Environment:

- Location Interior space
- Operating Temperature 0° to 50° C (32° to 112° F)
- Relative Humidity 10% to 95% Non-condensing
- Atmosphere Non-explosive, Non-corrosive
- Vibration Stationary application NEMA Level A

Certifications:

- UL, CUL recognized

Controller Inputs:

- 1-3 Momentary or Maintained inputs
- 1 Timer input Momentary
- 1 Master Override Input Maintained
- 1 Secondary Override Maintained
- ALL Inputs and Outputs programmable

Configuration:

- Factory programmed
- ILC field programming available

INTELLIGENT LIGHTING CONTROLS, INC.

5229 Edina Industrial Boulevard
 Minneapolis, Minnesota 55439
 Phone 952 829 1900
 FAX 952 829 1901
 1-800-922-8004
 www.ilc-usa.com

How to Order

Ordering a **DuraTouch** Control Module
 Order No. DT-JB (sample)

DT - _ _ _

Enclosure Type
 (J=Junction Box
 Mount, F=Fixture
 Mount)

Note: See CS 0617 for Touch Switch ordering information