

Apprentice 3 **NFP Series Switch Station**

Overview

NFP series switch plates are an attractive space-saving alternative to standard electrical wall switches. In addition to taking up less space than conventional wall switches (up to 8 switches on a 2-gang plate), NFP plates and switches can be ordered with either phenolic or engraved labeling to clearly identify the purpose of each switch. With optional LED pilot lights and a choice of colors and materials, NFP plates and switches provide an economical solution to many low voltage switching requirements.



Shown with optional LED

Features

- **Made in the USA**
- **Switches** are heavy duty momentary center OFF rockers
- **Direct** wire to lighting controller
- **Switch stations** handle up to 8 switches on a 2 gang plate
- **Switch colors** include black, white, gray, or red
- **Status LEDs** optional for each switch
- **Durable switch plates** come in brushed aluminum, stainless steel, white, and other colors
- **Hardware** is included for mounting and wiring
- **Mounts** in a standard single gang or 2 gang box
- **Engraving** is available for switch identification
- **Custom** configure number of gangs, switches, and colors
- **Program** each button to control any relay(s), group(s) or preset(s)

Warranty

One year limited warranty

Ordering

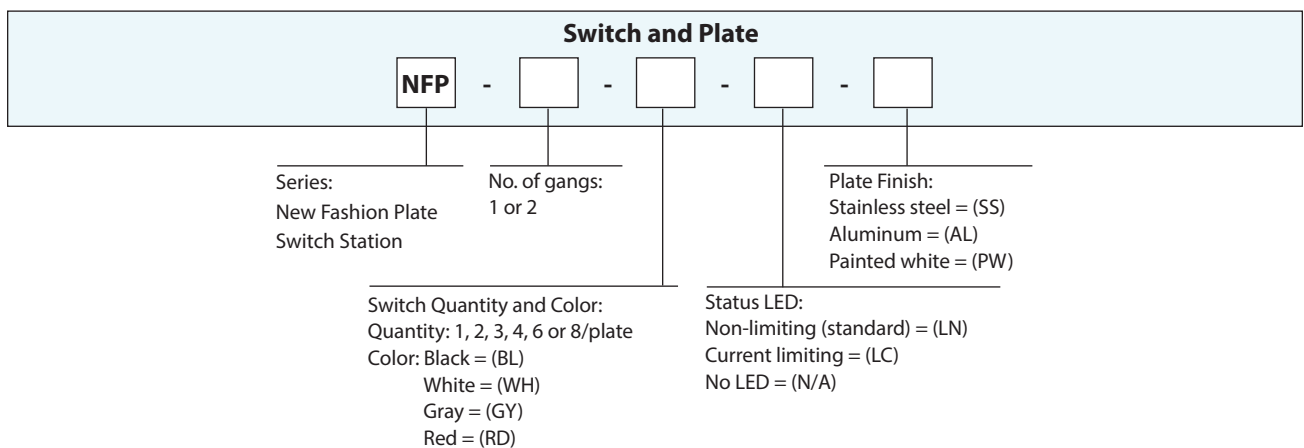

Apprentice 3

NFP Series Switch Station

Physical

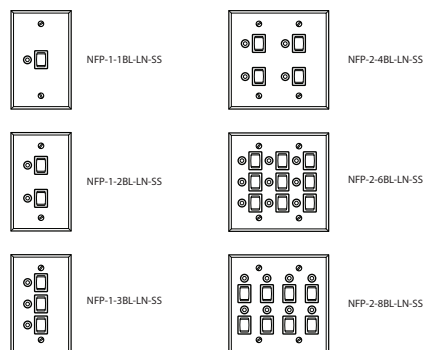
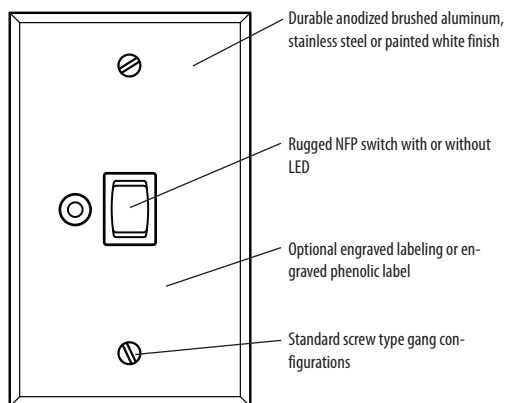

Custom NFP switch station configurations available

Specifications

Physical:

- Mounts in a 1 or 2 gang switch box
- Standard switch plate sizes
- Mounting screws provided
- Switch size: 9/16" x 13/16"
- Engraving up to 10 characters is available on phenolic labels or directly on plate surface
- Available in brushed aluminum, white, or stainless steel
- Status LED available with or without current limiting

Electrical:

- Momentary switched: 1 amp @ 24 VDC
- Momentary switched: 15 amp @ 125 VAC
- LED non-current limited: for LightLEEDer, LightMaster, or Apprentice II panels with internal limiting
- LED current limited: 30 VAC/VDC

Operating Environment:

- Location: Interior Space
- Operating Temp.: 0° to 60° C
- Humidity: 10% to 90% Non-condensing
- Atmosphere: Non-explosive/corrosive
- Vibration: Stationary