

LightLEEDer Panel Node Address

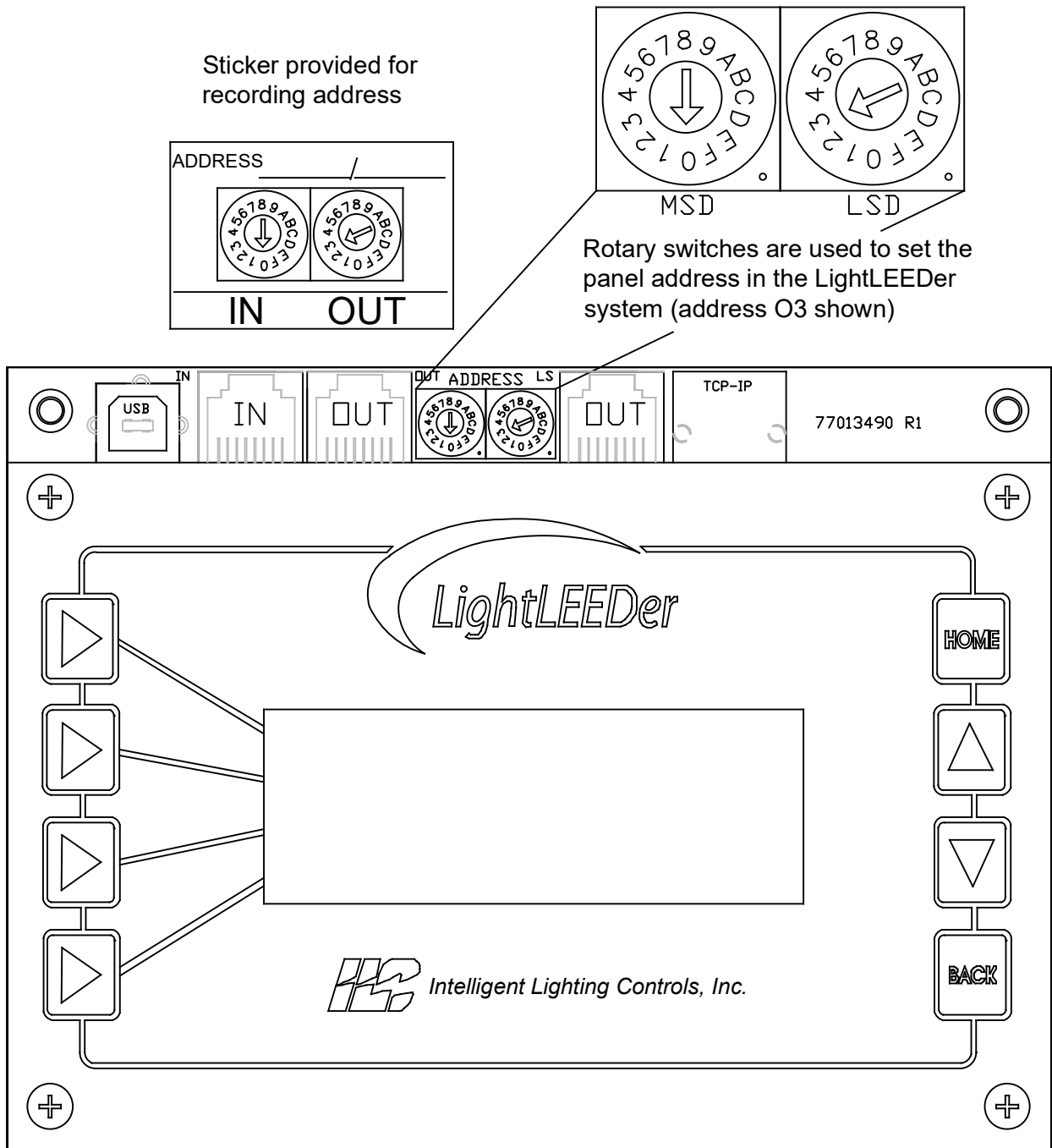

- Each LightLEEDer panel processor must be given a unique 2-digit node address using the rotary address switches shown above. 254 unique relay panel addresses are supported with the Hexadecimal addressing method (01 to FF).
- This 2-digit Hexadecimal address code system is also used with the network LightSync & Local data line devices as a subnet to the panel network.
- Record the LightLEEDer panel or LightSync device address on the provided sticker for future reference (they will be required for programming).