

Overview

The LightSync Photo Sensor Controller Averaging Module will allow monitoring of up to 8 LightSync Photo sensor controllers (LSPSC) and provide the LightLEEDer panel a averaged single sensor response. This module is typically used with the 4 sensor input controller (LSPCS-4), or several remote mount LSPCS modules. This averaging controller is used where sampling of the sunlight contribution in a large space needs to be done from multiple locations and then used to control loads across the entire area as one.

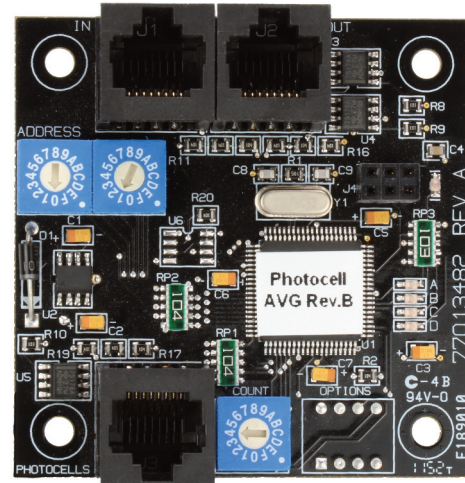

Features

- **Made in the USA**
- **Digital CAT 5** ready
- **Averages** up to 8 Photo Sensor Controllers
- **Provides all the functions** of a standard LSPSC module
- **Configured at LightLEEDer panel** as a single photo sensor device
- **Digitally addressable** device for a unique address
- **Remote mount (R)** provided with 4-11/16" J- box
- **Panel Mount with Plate (PR-P)** provided with mounting plate and 1-LSPSCAM with space for 1-LS module
- **Remote Enclosure (R2)** provided with 1-LSPSCAM and 1-LSPSC-4 module in a NEMA-1 enclosure

Warranty

Six-year limited warranty

Ordering

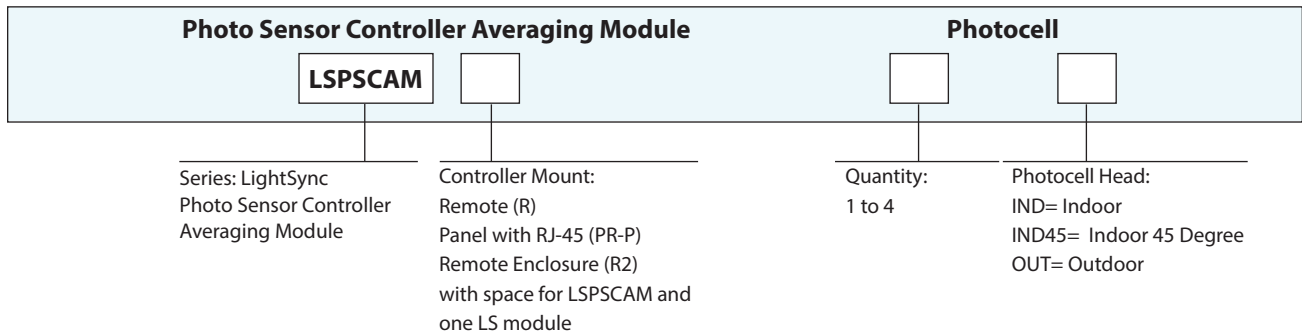

Note: When ordering a LSPSCAM-R2 option you must select the type of photo sensor head and quantity.

LightSync Digital

Photo Sensor Controller Averaging Module

Physical

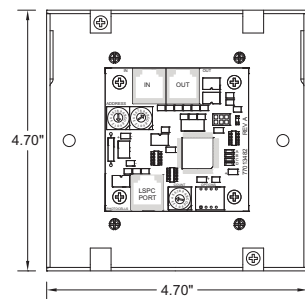

Remote Mount LSPSCAM-R

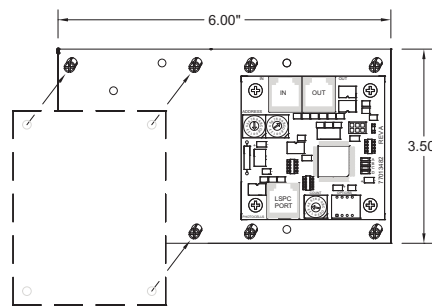
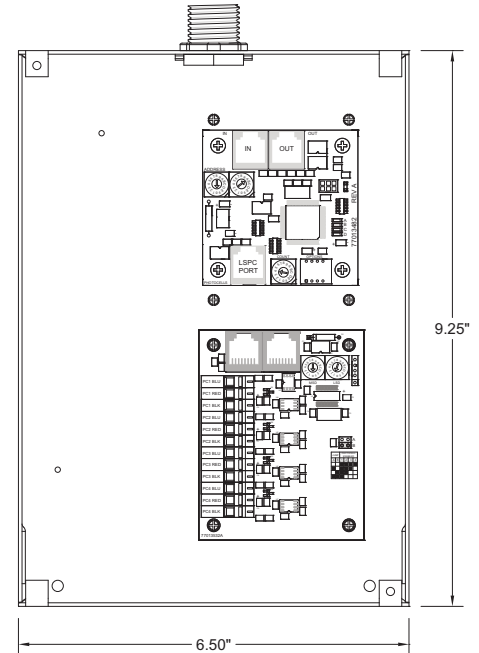
LSPSCAM-PR-P Panel Mount 2-Device Plate
(Shown with space for optional modules)LSPSCAM-R2 Remote Enclosure provided with
LSPSC-4 Photo Sensor 4-Input Module

Specifications

Controller Physical:

- 2.50" Wide x 2.50" High
- Digital addressing switches
- RJ45 connectors for LS data line connection
- R option provided with 4-11/16" junction box
- PR-P option provided with 6.0" x 3.5" mounting plate
- R2 option 6.5" x 9.25" Enclosure for 2 devices

Electrical:

- Powered from the panel or the LightSync network

Photocell Heads:

- Outdoor photocell mounts in a 1/2" LB type fitting or junction box
- Indoor photocell mounts to ceiling tile or other structure
- Indoor 45 degree photocell mounts to ceiling or other structure. Angled for light harvesting.

Controller Operating Environment:

- Location: Interior Space
- Operating Temp.: 0° to 50° C
- Humidity: 10% to 90% Non-condensing
- Atmosphere: Non-explosive/corrosive
- Vibration: Stationary

Photocell Operating Environment:

- Location: Interior/Exterior Space
- Operating Temp.: -35° to 50° C
- Humidity: 10% to 100% Condensing
- Atmosphere: Non-explosive/corrosive
- Vibration: Stationary

Certifications:

- UL CUL
- FCC Part 15