

**Apprentice3 BACnet Interface**

**Overview**

The Apprentice3 BACnet interface add-on module can easily be added to any Apprentice3 programmable lighting control panel to provide integration with your BACnet control system, allowing the panel to become a node on the BACnet network.

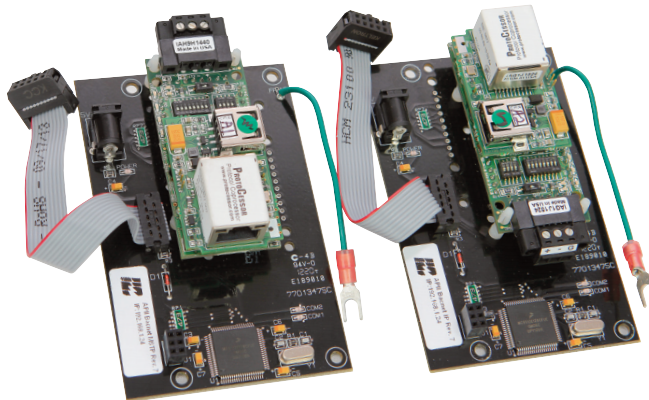

BACnet MSTP Board

BACnet IP Board

**Features**

- Made in the USA
- Factory set configuration
- Fully configurable via downloadable file
- Connect via RJ45 ethernet connection
- Bacnet-IP modules support HTTPS which use TLS/SSL certification

**Control and Status**

- Force relays ON or OFF
- Force relays ON or OFF with timer options
- Monitor hardwired **maintained** ON or OFF inputs for closures
- Enable or disable hardwired inputs

**Warranty**

One year limited warranty

**Ordering**

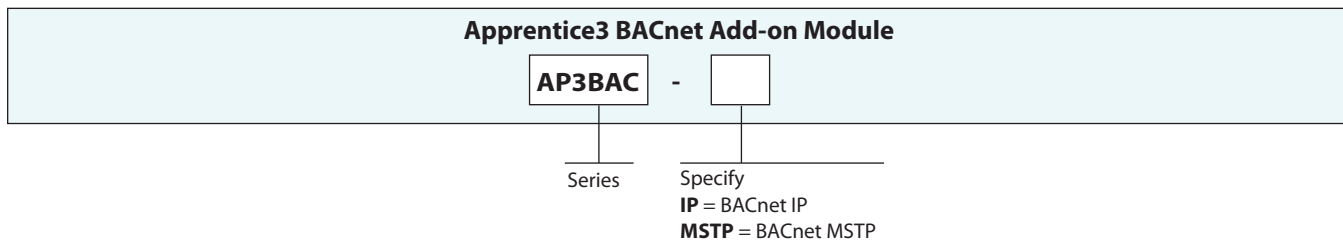

## Apprentice3

## BACnet Interface

## Physical

Apprentice3 BACnet MSTP Add-on Module

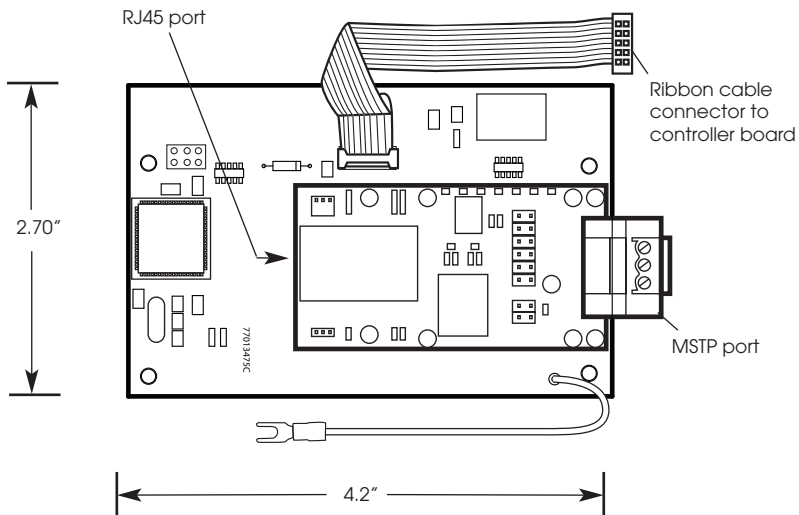

Apprentice3 BACnet IP Add-on Module

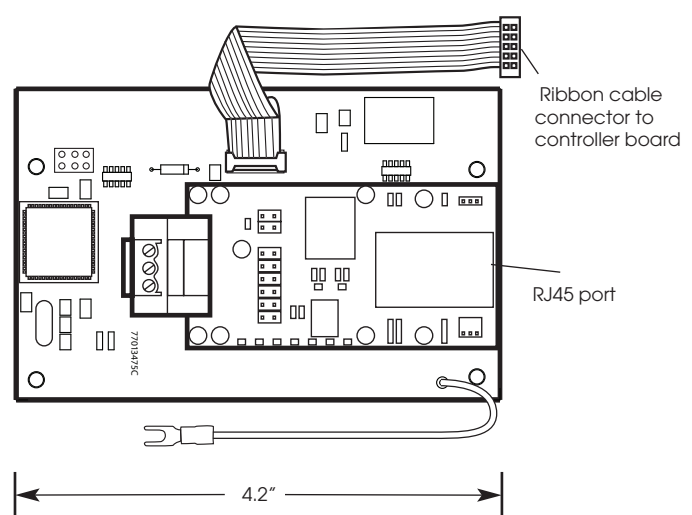

## Specifications

**Physical:**

- 2.70"W x 4.2"H x 1.25"D
- Plug-in module designed for mounting in the Apprentice 3 master panel

**Electrical:**

- Power consumption: 252mA @ 5VDC
- Power provided by external wall mount transformer

**Operating Environment:**

- Location Interior space
- Operating 0° to 50° C (32° to 112° F)  
Temperature
- Relative 10% to 90% Non-condensing  
Humidity

**Certifications:**

- Full protocol compliance
- UL CUL
- FCC Approved for commercial use
- BTL Mark