

Apprentice 3

LightSync G2 Data Line Switch Input

Overview

The LightSync Digital G2 Data Line Switch from ILC offers all the functionality of the standard LightSync switch and is even more affordable and flexible. Whether connected to a Apprentice3 or AP3-X panel network, a LightSync Switch provides the flexibility that you need for your lighting control application. Each switch button may be individually programmed to control any single relay, group of relays or presets within an individual AP3 panel or networked AP3-X panel on the LightSync data line network. Switches are equipped with common CAT-5 cable RJ-45 connectors for quick and easy installation on a AP3 LightSync data line network.



Available in White , Ivory and Gray

Features

- **Made in the USA**
- **Digital CAT 5** ready
- **Data line** pushbutton switch station
- **Buttons range** from 1 to 6 per station
- **Switches beep** audibly when activated
- **Program** each button to control any relay(s), group(s) or preset(s)
- **Switch locator LED** helps find the switch in a dark room
- **Status LEDs** indicate the true state of a relay, group or preset

- **Replaceable faceplates and buttons**
- **Mounts** in a standard single gang box
- **Laser engraving** is available for switch identification
- **Remote mount** anywhere on the LightSync network
- **Self powered** from the network
- **RJ45 connectors** provided for easy connection
- **Addressable** rotary switches
- **Decora®** style switch plate provided
- **Available in white, ivory, or gray**

Warranty

One-year limited warranty

Ordering

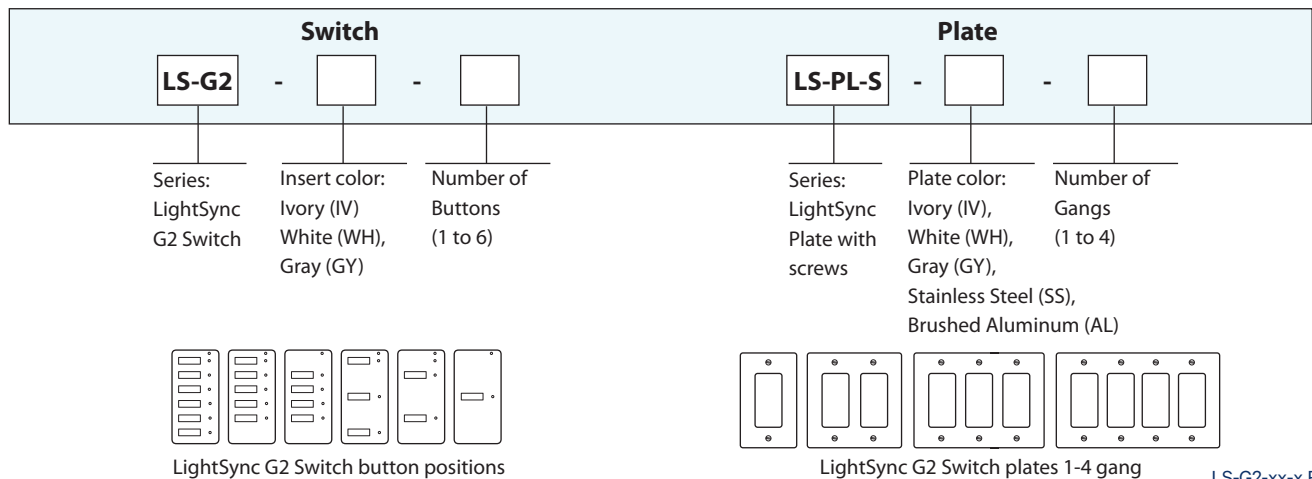

LS-G2-xx-x Rev.B

## Apprentice 3

## LightSync G2 Data Line Switch Input

## Physical

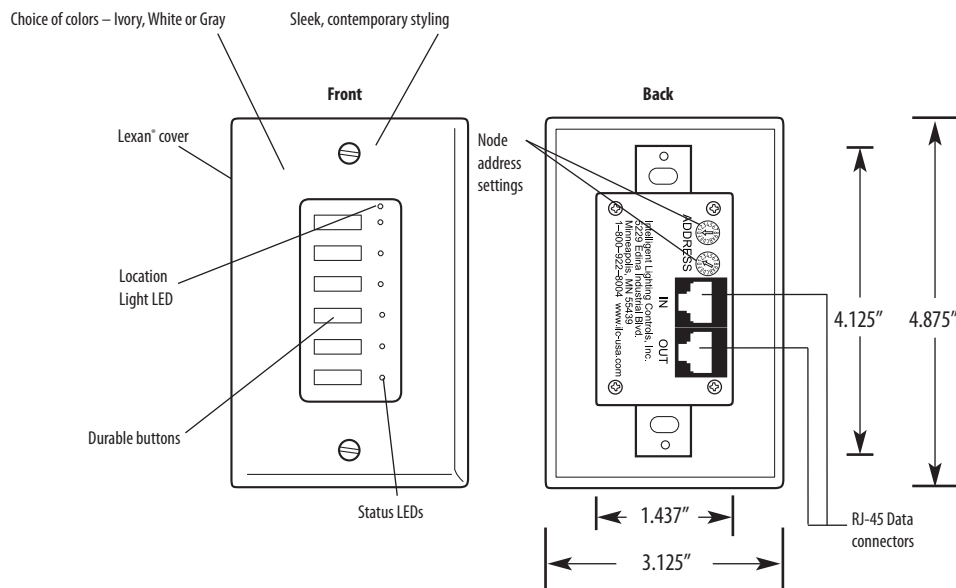

## Specifications

**Physical:**

- Standard single gang mounting
- Digital addressing switches
- RJ45 connectors provided for easy connection
- Switch plate is made of Lexan with screws provided
- Mounting screws provided
- Laser engraving up to 10 characters

**Switch Plates:**

- Brushed Aluminum (visible screws)
- Stainless Steel (visible screws)
- Painted (visible screws)

**Electrical:**

- Powered from the panel or LightSync network

**Operating Environment:**

- Location: Interior space
- Operating Temp.: 0° to 50° C
- Humidity: 10% - 90% Non-condensing
- Atmosphere: Non-explosive/corrosive
- Vibration: Stationary

**Certifications and Approvals:**

- UL CUL
- FCC Part 15