

# PUBLIC RESTROOM IECC 2021 DESIGN GUIDE

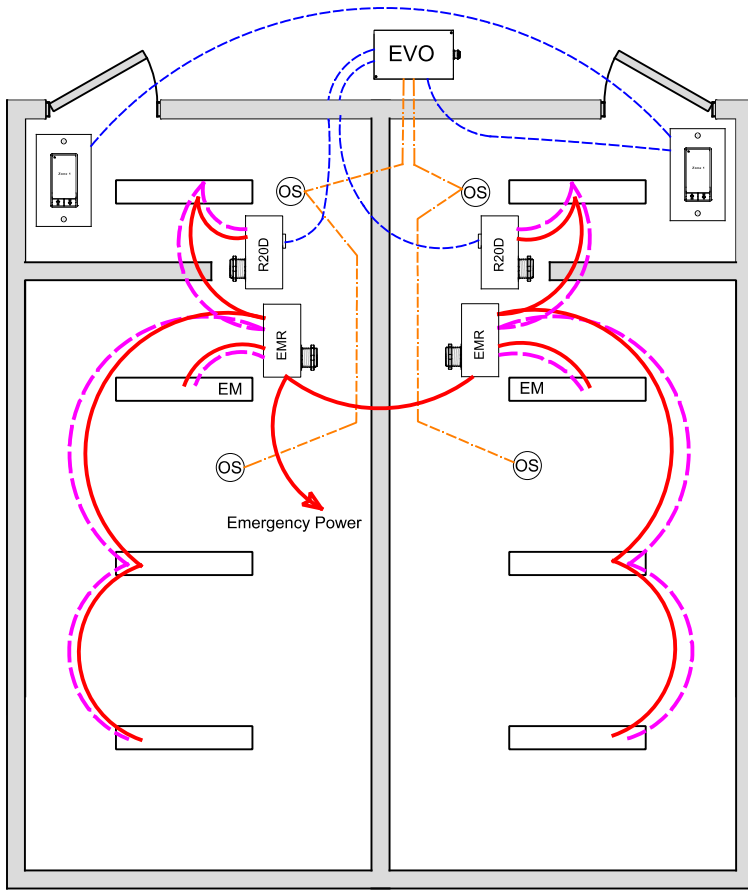

## OVERVIEW:

Lighting zone is controlled individually with 0-10V dimming per restroom, Occupancy or local digital control stations. On-50% /Off

## SEQUENCE OF OPERATION:

Lights turn on at digital switch station, raise/lower adjustable dim level. Occupancy sensor input set for auto On-50% and off after 20 minutes of vacancy. Dimmer outputs provide smooth full range control, zones can be set for adjustable start level from occupancy or digital switch.

Digital switch station provides individual zone on/off control and dimming.

## ADDITIONAL OPTIONS:

Multiple rooms can be controlled from a single 4-zones LLEVO panel, additional LSEVO-4X, -8X expansion panels available for up to 20 zones.

Additional LightSync switch stations as needed up to 32.

LLEVO control panel can connect to ILC network for building control (C405.2.2.1).

Emergency lighting control bypass relay for UL-924 can be added as needed.

### WIRE LEGEND

	Line voltage
	0-10V Dimming
	CAT-5e Data cable
	3-Wire Occupancy Sensor or Photo Sensor

### Bill Of Material:

Qt:	Product:	Description:
1	LLEVO	EVO Controller
2	R20D	Remote 20Amp Dimming relay
2	EMR	Emergency Relay UL924 with 0-10V dimming bypass
2	LSG3-WH-1-MZD	LightSync G3 1-Zone dimming digital switch station.
4	ILC-SWX-221-1	Occupancy sensor ceiling Dual Tech - 500sf

LLEVO Pre-Program: F7

## CODE REQUIREMENTS SUPPORTED:

Auto-Off from Occupancy sensor (C405.2.1.1)

Local Switch control (C405.2.2.3)