

STAIRWELL

WR20D-EM Wireless-Direct-Link

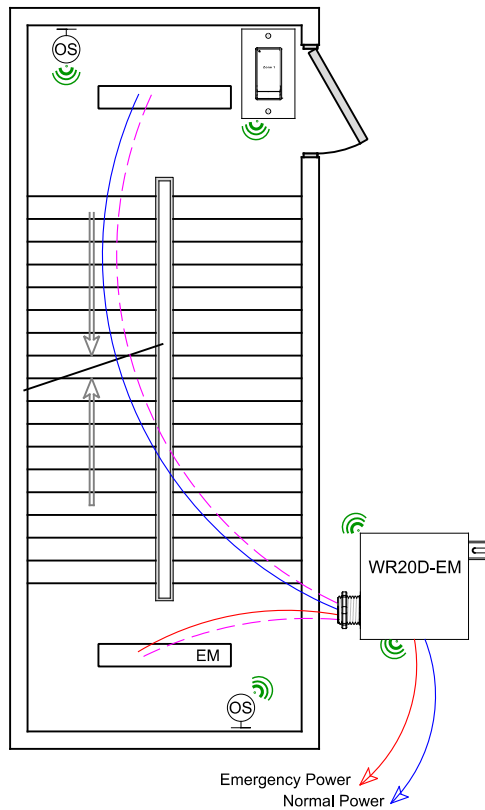

OVERVIEW:

Wireless devices are wireless-direct-linked to the control relay. Standard switch and sensor control operations are automatic.

RADIO DISTANCE:

Wireless radio distance is 100 feet line-of-sight. Radio distance is reduced through a standard construction wall, brick walls will reduce range further. Steel wall coverings, doors, and obstacles such as HVAC steel vent ducts or steel enclosures will block the radio signal.

SEQUENCE OF OPERATION:

Lights turn on at digital switch station, On to 100%. Occupancy sensor input set for auto - on-50%/off control.

UL 924 Emergency load control will match normal control output. If normal power is lost to the WR20D-EM then the EM relay will close and dimming will go to 100% non-dim level. All switch and occupancy commands are ignored when in EM mode.

ADDITIONAL OPTIONS:

Wireless devices can be linked to a LLEVO-W wireless controller for networking the controls.

CONNECTION LEGEND	
	Normal Power
	Emergency Power
	0-10V Dimming
	ILC 915Mhz radio

Bill Of Material:		
Qt:	Product:	Description:
1	WR20D-EM	Wireless 20Amp dimming relay and UL 924 Emergency relay
1	LSG3-W-WH-1	LightSync G3 Wireless 1-Zone Non-Dim digital switch station.
2	ILC-SWX-421-B	Occupancy sensor wall mount Dual Tech - Hallway

CODE REQUIREMENTS SUPPORTED:

Partial Auto-Off from Occupancy sensor
Multi-Level Dimming control
Time Schedule stand-alone or network
Local Switch control w/dimming